

Webasto Turbo DX™ 2.0 Plug-In Charging Station

QuickStart Guide

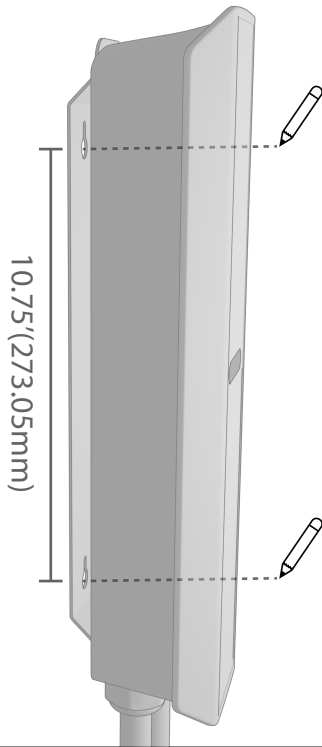

Find a stud and position the device with the attached bracket. Measure the hole spacing and mark drill locations. Remove the device and secure mounting screws into stud.



Insert the power adapter into the 14-50 receptacle to power to the unit. A solid blue light will indicate that the unit is operating properly and is ready to begin charging.

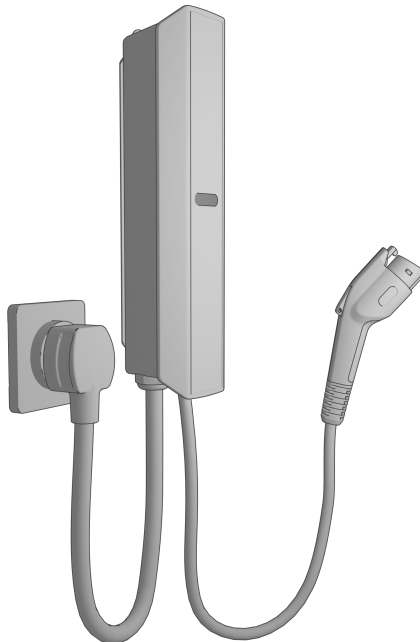

*depicted cable length is for illustrative purposes and does not represent actual length

Connect the coupler to the vehicle's charging port. The charger's LED will blink and illuminate a solid blue, indicating that charging has started.

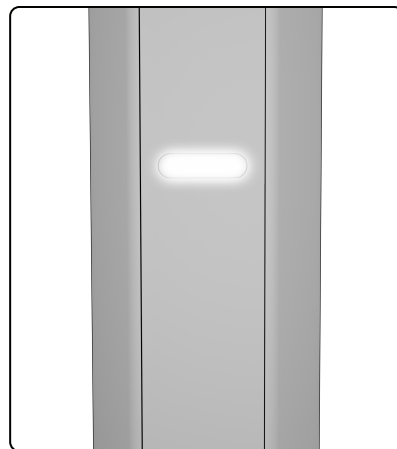
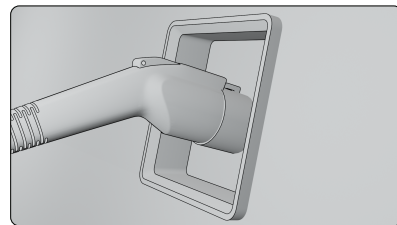

Product Guides & Resources

We are committed to sustainable processes and are reducing our environmental impact by offering documentation online.

Please visit <https://www.evsolutions.com/ev-charging-product-resources> to download product and user guides.

Customer Support Specialists

Our dedicated team of Customer Support Specialists is readily available to help answer any questions you might have. Please don't hesitate to contact us at (888) 833-2148.

Join the Conversation

Like, comment, share, and connect with our growing EV community.



facebook.com/webastoevus



[@webastoevus](https://twitter.com/webastoevus)



[@webastoevusa](https://www.instagram.com/webastoevusa)



[webasto-ev-solutions-us](https://www.linkedin.com/company/webasto-ev-solutions-us)
[webasto-charging-systems-inc.](https://www.linkedin.com/company/webasto-charging-systems-inc)